

High-Pressure PET Kegs Are Explosive!

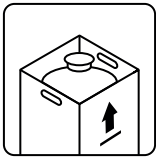

Be careful! Follow the instruction!



The keg must be in upright position

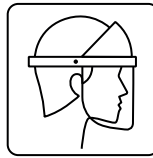

Use protective face equipment at all stages

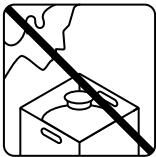

Do not bend over the PET keg

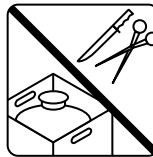

Take care any sharp objects do not touch the keg



It is dangerous!
– to lean it
– to drop it
– to throw it

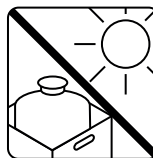

Do not take the keg out of the box. It protects the keg against damages and against the sun

Transportation and storage:

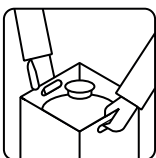

Only two may carry and move the box



Do not move the filled keg on slippery floor

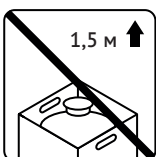

Do not hoist the keg to the height of over 1.5 m

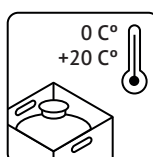

The storage temperature recommended is 0° C to +20° C

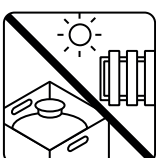

Do not keep the keg in the sun or near to heating units

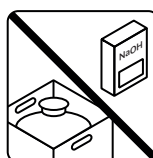

Keg contacting to detergents (alkali) is dangerous!

Connecting and operating:



Filling under the CO2 pressure of over 3 bars is prohibited

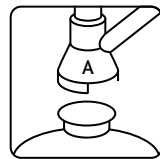

Use only the PET keys with the different filling caps of relevant types

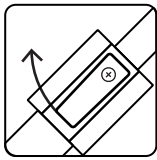

Before connecting, turn on CO2 in the dispenser

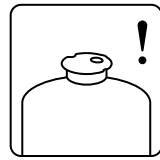

Make sure that there are no damages, foreign objects, or dirt on the spears or mounting surface



Treat the cap with a disinfectant solution

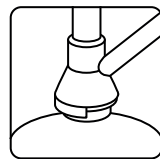

Place and center the filling cap. If it is difficult to place it, the filling cap is defective!

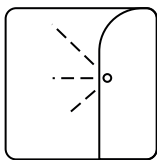

Make sure that there are no leaks of gas or product (no eervescence)

It is prohibited!

To remove the filling cap very often

To move or rotate the keg using the handle of the filling cap

To twist on the valve

Attention! An empty keg is still under pressure!
Discharge the pressure before removing the filling cap.

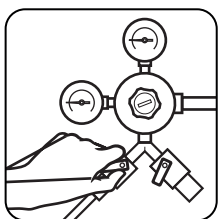

1

Lock CO2 feeding

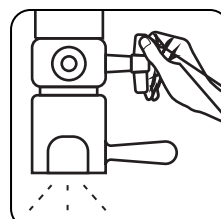

2

Turn on the filling tap and release the pressure

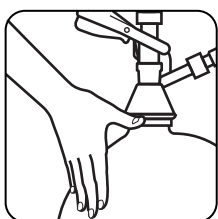

3

Press the keg to make sure that it is soft

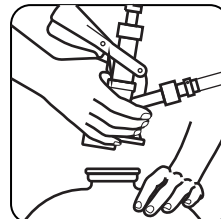

4

Remove the filling cap from the keg spear

CO2